

# Zehnder Fina Lean Bar

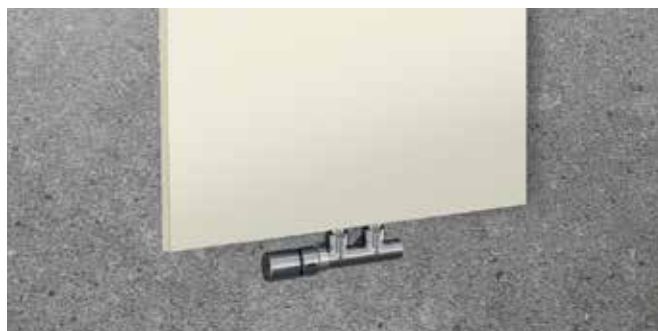

Radiator surface: Cream



## Operation on central heating system

Zehnder Fina Lean Bar decorative radiator with smooth front panel made of sheet steel in elegant and slim design, even surface and rounded sides for mounting desired towel rails. One towel rail included in scope of delivery. Heat output according to EN 442, with CE marking. With 2 x 1/2" female thread connection for flow/return at bottom centre, spacing 50 mm, air vent 1/2" at top in back. Radiator with powder coating, in colour RAL 9016 as standard, in special colour on request. Delivered ready to install with wall brackets and packaging.

Operating pressure	max. 6,0 bar
Operating temperature	max. 110 °C
Height	..... mm
Length	..... mm
Model	.....

## Benefits

- Slim, elegant design
- Easy to clean due to smooth surface
- Convenient hanging of towels with height-adjustable towel rail in chrome
- Optional: additional towel rail for hanging up more towels
- Pleasant warmth due to high proportion of radiation

## Electric-only operation

Zehnder Fina Lean Bar decorative radiator with smooth front panel made of sheet steel in elegant and slim design, even surface and rounded sides for mounting desired towel rails. One towel rail included in scope of delivery. Radiator with sheet steel on the back side, an inside heating wire and a graphite plate between heating wire and front for even and fast heat distribution. With CE marking. Separate, battery-operated remote control device model 2, heating element RACY-S without visible control components on the radiator. Splash-proof IP44, mains connection 230 V. Connection cable 1.2 m long with Schuko plug. Radiator with powder coating, in colour RAL 9016 as standard, in special colour on request. Delivered ready to install with wall brackets and packaging.

## Standard scope of delivery for operation on central heating system

- Powder coating to DIN 55900, RAL 9016
- Towel rail in chrome
- 2 x 1/2" connections at bottom, centric 50 mm
- 1/2" air vent
- Mounting accessories in colour of radiator
- Packaging

## Special advantages for electric operation RACY-S

- Aesthetically appealing design due to concealed electric heating element
- Flexible control options: control device for wall mounting or base.
- Diverse adjustment options: Regulated room temperature or operation in energy-saving or frost-protection mode
- Customizable daily and weekly programmed for convenient, on-demand operation
- Energy-efficient and comfortable heating with innovative open window detection
- Low energy consumption of only 0.5 W in stand-by mode for increased energy efficiency
- Timer function for on-demand operation. Ready-to-plug for easy and quick installation

# Zehnder Fina Lean Bar

## Overview of models

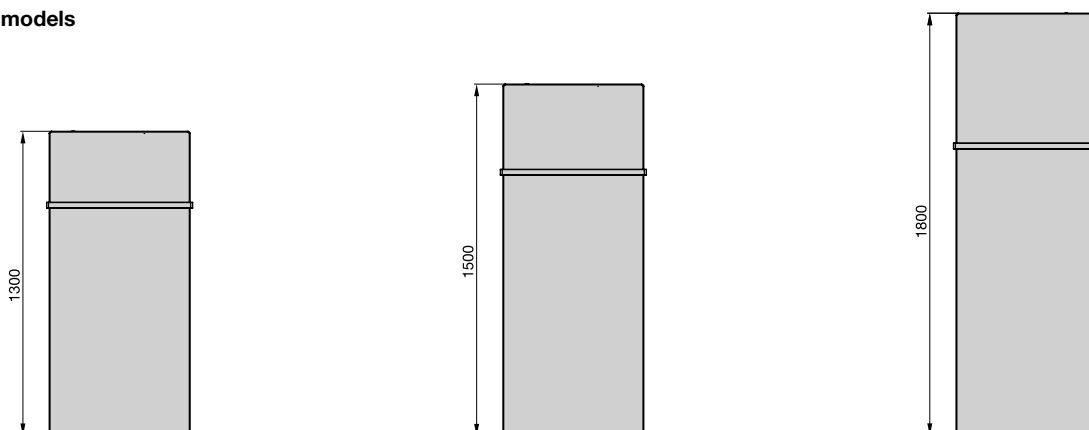

## Connection to hot water central heating system

Painted version

Model	H mm	L mm	Thermal output				Exp. n	Output electric Watt	V dm <sup>3</sup>	M kg	Price RAL 9016 €	Price <sup>①</sup> Cat. 1 €
			EN 442 <sup>②</sup> Watt	70/55/24 Watt	55/45/24 Watt	55/45/20 Watt						
<b>FIF-130-050</b>	1300	500	620	444	274	328	1,23	-	0,90	20,9	<b>942,39</b>	<b>1.177,99</b>
<b>FIF-150-050</b>	1500	500	717	516	321	383	1,21	-	1,10	23,7	<b>969,51</b>	<b>1.211,89</b>
<b>FIF-180-050</b>	1800	500	863	619	382	458	1,23	-	1,30	28,7	<b>1.010,18</b>	<b>1.262,73</b>
<b>FIF-130-060</b>	1300	600	723	519	321	384	1,23	-	1,20	24,7	<b>969,51</b>	<b>1.211,89</b>
<b>FIF-150-060</b>	1500	600	837	600	371	444	1,23	-	1,40	28,3	<b>996,63</b>	<b>1.245,79</b>
<b>FIF-180-060</b>	1800	600	1008	719	441	529	1,25	-	1,50	31,4	<b>1.044,08</b>	<b>1.305,10</b>
<b>FIF-130-070</b>	1300	700	824	592	367	439	1,22	-	1,50	28,5	<b>1.023,75</b>	<b>1.279,70</b>
<b>FIF-150-070</b>	1500	700	954	682	420	503	1,24	-	1,70	32,9	<b>1.057,65</b>	<b>1.322,06</b>
<b>FIF-180-070</b>	1800	700	1148	814	495	596	1,27	-	1,80	39,6	<b>1.105,11</b>	<b>1.381,38</b>

## Electric-only operation

Painted version



Model	H mm	L mm	Output electric Watt	Price RAL 9016 €	Price <sup>①</sup> Cat. 1 €
<b>FIFE-130-050/D</b>	1300	500	350	<b>1.328,84</b>	<b>1.528,16</b>
<b>FIFE-150-050/D</b>	1500	500	500	<b>1.450,88</b>	<b>1.668,50</b>
<b>FIFE-180-050/D</b>	1800	500	500	<b>1.600,03</b>	<b>1.840,03</b>
<b>FIFE-180-060/D</b>	1800	600	750	<b>1.735,62</b>	<b>1.995,96</b>
<b>FIFE-180-070/D</b>	1800	700	750	<b>1.884,78</b>	<b>2.167,50</b>

## Standard scope of delivery for operation on hot water heating system

- Powder coating to DIN 55900, RAL 9016
- Towel rail in chrome plated
- 2 x 1/2" connections, bottom center 50 mm
- 1 x 1/2" air vent
- Mounting accessories in colour of radiator
- Packaging

## Standard scope of delivery for electric operation

- Powder coating to DIN 55900, RAL 9016
- Remote control device, incl. battery, with selectable operating modes: manual (above room temperature), weekly programme, timer, off
- Towel rail in chrome plated
- Mounting accessories in colour of radiator
- Packaging

Special solution on request (surcharge)	Article number	Price €
■ Special finish to category 2 (surcharge on cat. 1)	FI00011640	<b>146,76</b>
■ Towel rail in chrome for radiator length 500 mm	481408	<b>162,72</b>
■ Towel rail in chrome for radiator length 600 mm	481418	<b>169,48</b>
■ Towel rail in chrome for radiator length 700 mm	481428	<b>176,27</b>
■ Zehnder thermostats	-	<b>See page 164</b>
■ Zehnder valves, return screw connections and connection fittings	-	<b>See p. 165 onwards</b>

① For special colours in categories 1 and 2, see special solutions and colour chart

② Thermal output to EN 442, ΔT 50 K (75/65/20 °C)

# Zehnder Fina Lean Bar



## Operation on central heating system: Wall mounting

Back side

## Electric operation: Wall mounting

Back side

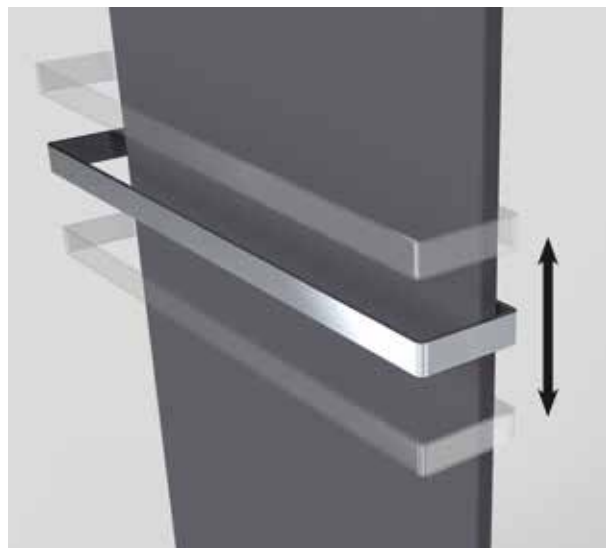
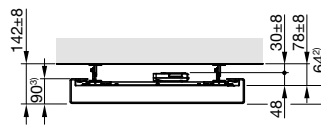
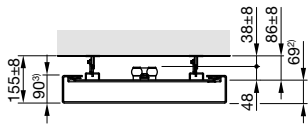
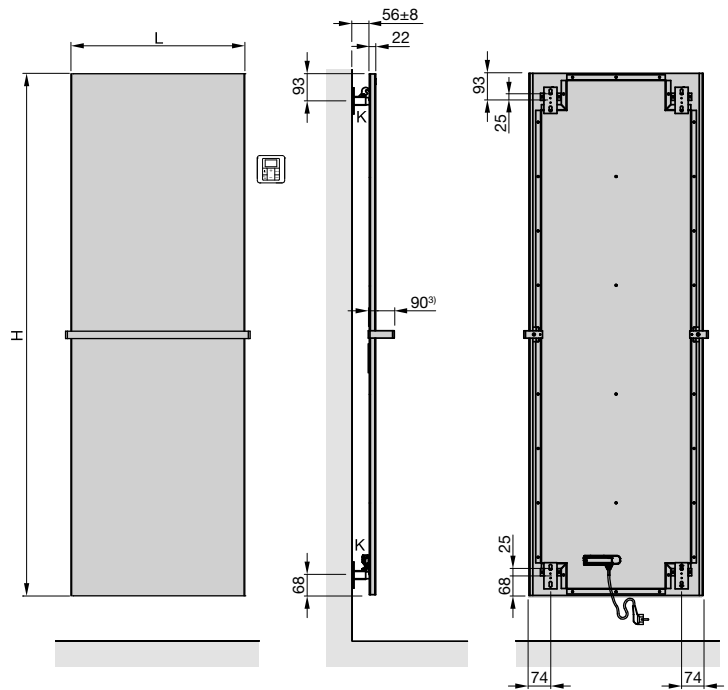
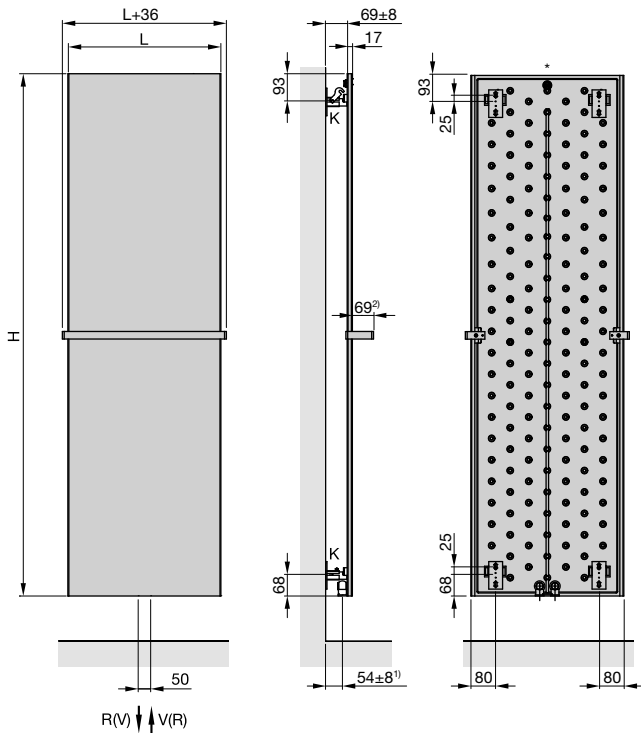

Towel rail is easy to adjust and can be positioned at any height.

## Operation on central heating system: Detail suspension lug

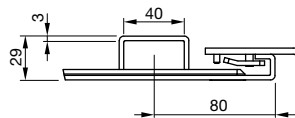

## Electric operation: Detail suspension lug

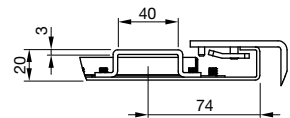

- H = Height
- L = Length
- V = Flow 1/2"
- R = Return 1/2"
- \* = Venting 1/2"
- K = Bracket

Dimensions in mm

- 1) Distance from wall to middle of connection
- 2) Front edge of towel rail to front edge of radiator
- 3) Depth towel rail